

CUSTOM X-3000 GT

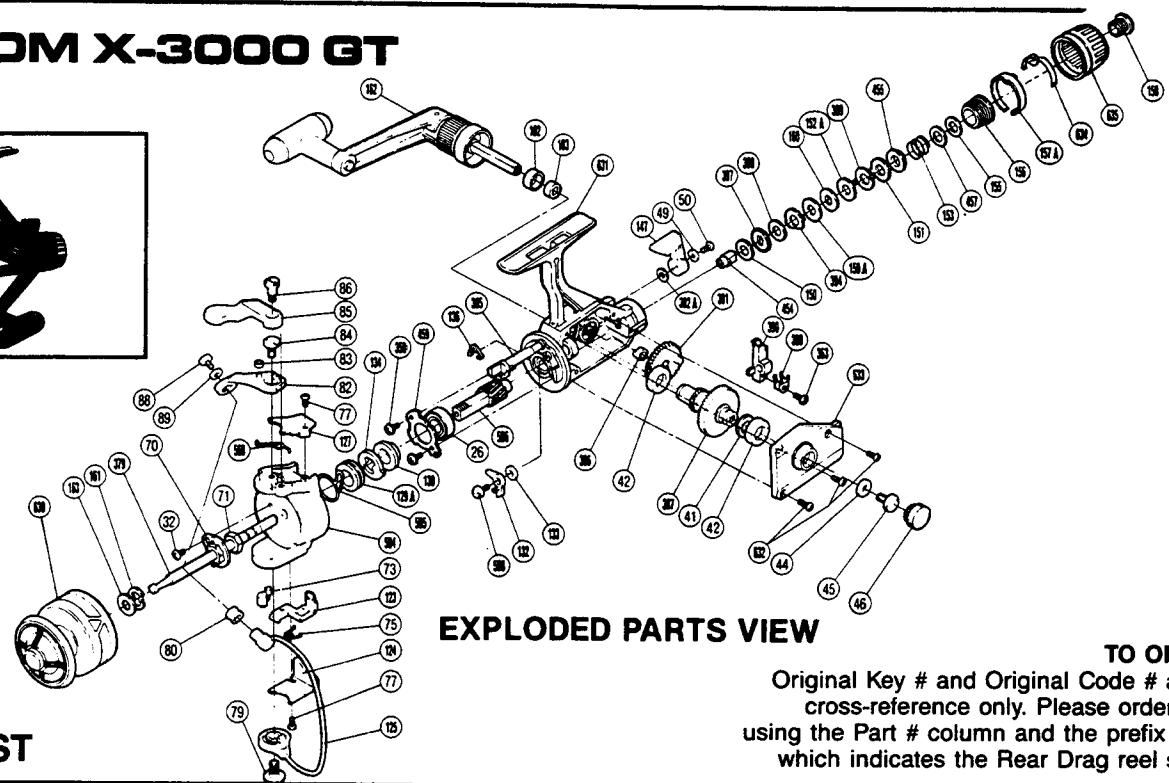
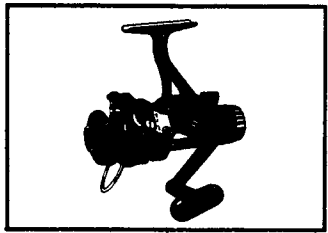

EXPLODED PARTS VIEW

PARTS LIST

TO ORDER
Original Key # and Original Code # are cross-reference only. Please order parts using the Part # column and the prefix "F" which indicates the Rear Drag reel ser

| PART # | ORIGINAL KEY # | ORIGINAL CODE # | DESCRIPTION | PART # | ORIGINAL KEY # | ORIGINAL CODE # | DESCRIPTION |
|--------|----------------|-----------------|----------------------------|--------|----------------|-----------------|--------------------------------|
| 630. | 1. | 6-0209 31203S | Spool Assembly | 42. | 41. | 7-0617 26100S | Drive Gear Bushing |
| 163. | 2. | 7-0217 26300S | Spool Washer | 387. | 42. | 7-0408 27200S | Drive Gear |
| 161. | 3. | 7-2101 09100S | Tension Spring | 41. | 43. | 7-0446 01100S | Drive Gear Washer |
| 379. | 4. | 6-0219 27330S | Main Shaft Assembly | 632. | 44. | 7-0011 40302S | Side Cover Screw |
| 32. | 5. | 7-0014 30100S | Nut Lock Screw | 44. | 45. | 7-0725 05500S | Handle Lock Washer |
| 70. | 6. | 7-0360 26200S | Rotor Nut Lock Plate | 45. | 46. | 7-0710 05100S | Handle Lock Screw |
| 71. | 7. | 7-0311 01100S | Rotor Nut | 46. | 47. | 7-0453 26100S | Handle Screw Cap |
| 594. | 8. | 7-0301 29321S | Rotor | 391. | 48. | 6-0449 27330S | Oscillating Gear Assembly |
| 73. | 9. | 7-0355 21200S | Bail Trip Slide Cam | 390. | 49. | 7-0410 29320S | Slider Oscillating Slider |
| 123. | 10. | 7-0336 21300S | Bail Trip Lever | 389. | 50. | 7-0538 29300S | Oscillating Slider Retainer |
| 75. | 11. | 7-0337 21200S | Lever Spring | 363. | 51. | 7-0014 30120S | Retainer Retainer Screw |
| 124. | 12. | 7-0338 21800S | Bail Trip Cover | 633. | 52. | 6-0609 31300S | Side Cover Assembly |
| 77. | 13. | 7-0013 30100S | Cover Screw | 392A. | 53. | | Anti-Reverse Lever Washer |
| 125. | 14. | 6-0309 26300S | Bail | 147. | 54. | 7-0404 26300S | Anti-Reverse Lever |
| 79. | 15. | 7-0335 14000S | Bail Trip Cam Screw | 49. | 55. | 7-0023 15300S | Lock Washer |
| 80. | 16. | 7-0304 01100S | Line Roller | 50. | 56. | 7-0013 00100S | Anti-Reverse Lever Screw |
| 127. | 17. | 7-0307 21800S | Bail Spring Cover | 454. | 57. | 7-0112 26300S | Drag Shaft |
| 82. | 18. | 7-0303 21700S | Bail Arm | 150. | 58. | 7-0139 26300S | Drag Washer "C" |
| 83. | 19. | 7-0356 21700S | Trigger Pin Roller | 397. | 59. | 7-0113 29300S | Click Gear |
| 84. | 20. | 7-0306 21700S | Bail Arm Screw | 398. | 60. | 7-0144 29300S | Drag Washer "E" |
| 85. | 21. | 7-0357 21700S | Quick-Fire Trigger | 394. | 61. | 7-0147 29300S | Eared Washer "G" |
| 86. | 22. | 7-0358 21700S | Trigger Screw | 160. | 62. | 7-0115 26300S | Key Washer "A" |
| 88. | 23. | 7-0013 40410S | Line Roller Screw | 152A. | 63. | 7-0140 26310S | Drag Washer "D" |
| 89. | 24. | 7-0316 01100S | Lock Washer | 399. | 64. | 7-0116 29300S | Eared Washer "B ₂ " |
| 568. | 25. | 7-0310 19301S | Bail Spring | 153. | 65. | 7-0119 26300S | Drag Coil Spring |
| 595. | 26. | 7-0422 21800S | Anti-Reverse Pawl Spring | 457. | 66. | 7-0135 26300S | Drag Spring Washer "A" |
| 129A. | 27. | 7-0498 29320S | Anti-Reverse Spring Holder | 155. | 67. | 7-0136 26300S | Drag Spring Washer "B" |
| 134. | 28. | 7-0421 21800S | Anti-Reverse Ratchet | 156. | 68. | 7-0110 26300S | Pressure Screw |
| 130. | 29. | 7-0428 21300S | Pinion Spacer | 157A. | 69. | 7-0143 26300S | Stop Ring |
| 358. | 30. | 7-0011 30470S | Bearing Retainer Screw | 634. | 70. | 7-0138 26301S | Drag Knob Click Spring |
| 459. | 31. | 7-0403 29730S | Bearing Retainer | 635. | 71. | 6-0109 26301S | Drag Knob |
| 26. | 32. | 7-0402 19300S | Ball Bearing | 158. | 72. | 7-0134 26300S | Drag Knob Screw |
| 596. | 33. | 7-0407 29320S | Pinion Gear | 162. | 73. | 6-0709 27330S | Handle Assembly |
| 136. | 34. | 7-0426 21300S | Anti-Reverse Cam Spring | 102. | 74. | 7-0731 26200S | Handle Lock Ring |
| 385. | 35. | 7-0424 29320S | Anti-Reverse Cam | 103. | 75. | 7-0743 26200S | Handle Lock Spacer |
| 598. | 36. | 7-0425 29300S | Anti-Reverse Pawl Screw | 455. | 76. | 7-0152 26300S | Drag Spring Washer "C" |
| 132. | 37. | 6-0419 21800S | Anti-Reverse Pawl Assembly | 150A. | 77. | 7-0139 26310S | Drag Washer "C ₂ " |
| 133. | 38. | 7-0457 05800S | Anti-Reverse Pawl Spacer | 151. | 78. | 7-0116 26300S | Eared Washer "B ₁ " |
| 631. | 39. | 6-0409 31300S | Body | | | | |
| 386. | 40. | 7-0537 29300S | Oscillating Gear Bushing | | | | |